

Increased Safety and Dust Ignition Proof Junction Boxes (Ex e and Ex tD)

EA/DA Range Aluminum Junction Boxes

Specifications: EA/DA

Classification	Zone 1, 2, 21 & 22 Gas Group IIC
Temperature class	T6/T5
Ambient temperature	-20°C to +65°C (+40°C & +55°C)
Approvals	IECEX SIM 08.0017X SIRA 09ATX3178X AUS EX 1173X (DE2, DIP, IP65) AUS EX 1176X (DE3, DIP, IP65) AUS EX 1184X (DE3, EX e, IP65)
Degree of protection	IP 66
Rated voltage	415 V
Standard finish	Cast from CP601 marine grade aluminum
Material	Stainless steel hexagon screws
Gaskets	Neoprene

Description

The EA/DA range of junction boxes are certified by Standards Australia for installation in Group II hazardous gas and dust areas. They are also suitable for heavy duty industrial use both indoor and outdoor.

Product



EA/DA 7535

EA/DA 1608

EA/DA 2020

Ordering Information Data Table

Dimensions [mm] and approx. Weight [Kg]

Type	Dimension			Maximum power dissipations (W)			
	H	W	D	T6/T80°C (Ta 40°C)	T5/T95°C (Ta 40°C)	T6/T80°C (Ta 55°C)	T5/T95°C (Ta 55°C)
EA/DA 1608	173	98	74	13	17	8.5	13
EA/DA 2020	210	210	155	23.5	29.5	14.5	23.5
EA/DA 3030	305	305	160	41	51.5	25	41
EA/DA 7535	750	305	155	61	76.5	38	61
EA 7535-BUS	750	305	155	76.50	76.50		86

Type	Maximum number of terminals				
	2.5mm ²	4mm ²	6mm ²	10mm ²	16mm ²
EA/DA 1608	12	12	-	-	-
EA/DA 2020					
EA/DA 3030					
EA/DA 7535					

Other terminal sizes and numbers available on request

Note: Other terminal sizes or combinations of terminals available on request.

This datasheet does not constitute any contract obligation.

Pepperl+Fuchs reserves the right to modify the products herein illustrated without prior notice.

Pepperl+Fuchs Group
www.pepperl-fuchs.com

USA: +1 330 486 0002
pa-info@us.pepperl-fuchs.com

Germany: +49 621 776 2222
pa-info@de.pepperl-fuchs.com

Copyright Pepperl+Fuchs
Singapore: +65 6779 9091
pa-info@sg.pepperl-fuchs.com

PEPPERL+FUCHS
PROTECTING YOUR PROCESS

Increased Safety and Dust Ignition Proof Junction Boxes (Ex e and Ex tD)

EA/DA Range Aluminum Junction Boxes

Specifications: EA/DA 1608

Materials	Cast Aluminum
Approx. Weight	1.5kg

Specifications: EA/DA 2020

Materials	Cast Aluminum
Approx. Weight	4.2kg

Specifications: EA/DA 3030

Materials	Cast Aluminum
Approx. Weight	9.5kg

Specifications: EA/DA 7535

Materials	Cast Aluminum
Approx. Weight	18.5kg

Product



EA/DA Range (Aluminium)

Drawing

EA/DA 1608

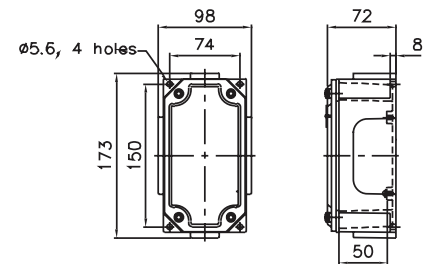

EA/DA 2020

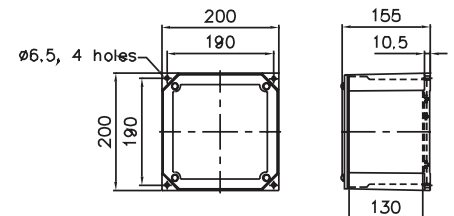

EA/DA 3030

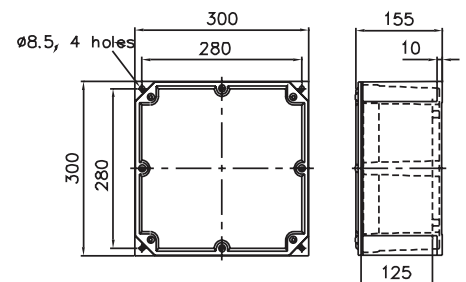

EA/DA 7535

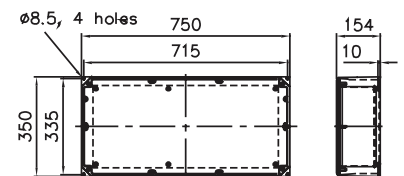

Ordering Information Data Table

Dimensions [mm] and approx. Weight [Kg]

Enclosure	Side	Maximum number of entries					
Type		M20	M25	M32	M40	M50	M63
EA 1608	Short	1	1	-	-	-	-
EA 2020	All	6	6	2	2	1	-
EA 3030	All	10	8	5	3	2	2
EA 7535	Short	19	11	6	3	3	3
EA 7535	Long	30	23	15	10	8	6
DA 1608	Long	2	2	1	-	-	-
DA 2020	All	6	6	2	2	1	-
DA 3030	All	10	8	5	3	2	2

This datasheet does not constitute any contract obligation.

Pepperl+Fuchs reserves the right to modify the products herein illustrated without prior notice.

Pepperl+Fuchs Group
www.pepperl-fuchs.com

USA: +1 330 486 0002
pa-info@us.pepperl-fuchs.com

Germany: +49 621 776 2222
pa-info@de.pepperl-fuchs.com

Copyright Pepperl+Fuchs
Singapore: +65 6779 9091
pa-info@sg.pepperl-fuchs.com