

Flameproof Junction Boxes (Ex d)

F150 and FH150 Junction Boxes

Specifications: F150 and FH150

Classification	IEC 60079-0 IEC 60079-1
Temperature class	T6
Ambient temperature	-20°C to +60°C (+40°C & +55°C)
Approvals	IECEx TSA 06.0054 IECEx SIR 12.0108 SIRA 07ATEX1135X II 2 G Ex d IIB T6 IP 66 Ex d IIB + H2 T6 IP 66
F150 - FH150 -	
Degree of protection	IP 66
Weight	15.5 kg
Standard finish	Cast aluminum / Stainless steel hardware

Description

The F150 is made from standard or marine grades of aluminum and comes complete with stainless steel hardware. Fixing is by means of four feet cast into the enclosure. Entries are possible on all sides.

Product



F150 & FH150

Drawing

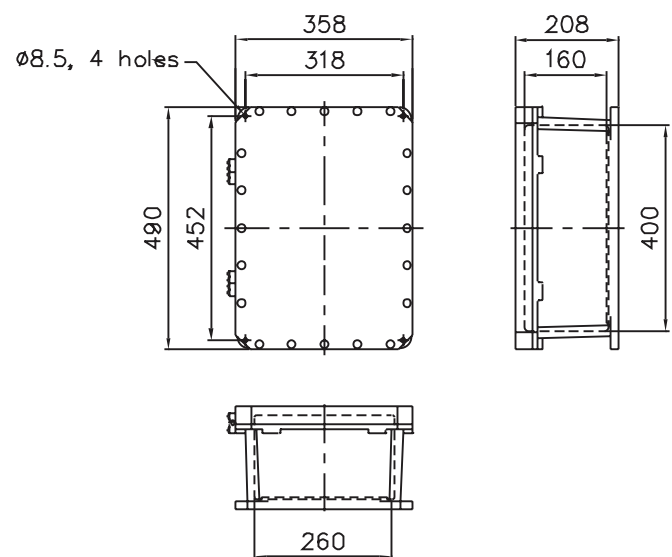

F150 & FH150

Maximum Number of Entries Per Side Data Table

Entry location	M20	M25	M32	M40	M50
Long side	26	18	12	8	6
Short side	12	8	6	5	3

Maximum Number of Entries Per Side¹⁾ Data Table

Entry location	½"	¾"	1"	1 - ¼"	1 - ½"	2"
Long side	26	18	12	8	6	4
Short side	12	8	6	5	3	2

This datasheet does not constitute any contract obligation.

Pepperl+Fuchs reserves the right to modify the products herein illustrated without prior notice.

Pepperl+Fuchs Group
www.pepperl-fuchs.com

USA: +1 330 486 0002
pa-info@us.pepperl-fuchs.com

Germany: +49 621 776 2222
pa-info@de.pepperl-fuchs.com

Copyright Pepperl+Fuchs
Singapore: +65 6779 9091
pa-info@sg.pepperl-fuchs.com

PEPPERL+FUCHS
PROTECTING YOUR PROCESS